

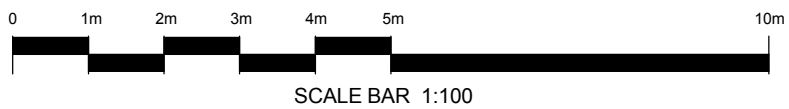

POWERHOUSE

SERVICED UNIT SA06

| | |
|---------|-----|
| LEVEL | 1FL |
| LIVING | 50 |
| BALCONY | 5 |

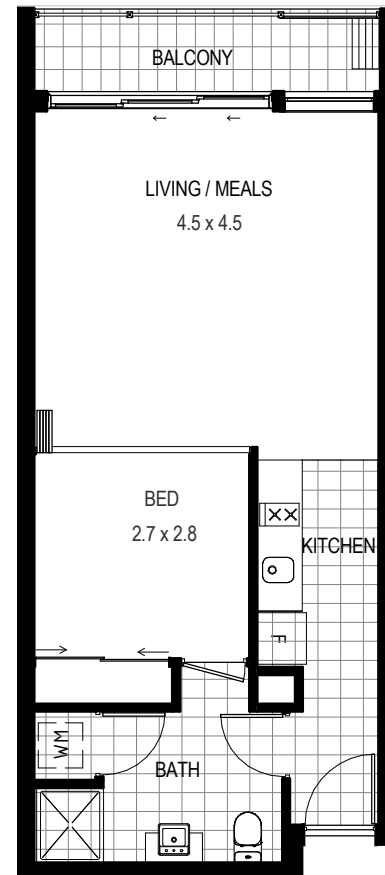

Disclaimer: All plans are subject to Development Application Approval. The area of each unit is calculated to the outside of external walls and centre of common walls in accordance with ACTPLA Gross Floor Area guidelines. All areas are in square meters (m²). Buyers responsibility is to verify and ensure that the drawings and information obtained from this document is the latest version. We reserve the right to change the drawings and any information contained in this document. By accessing this document you agree to the terms and conditions above. Fittings and fixtures are indicative only - refer to builders inclusions list.